

CabArray™ Executive Down Installation Guide

Ceiling Components

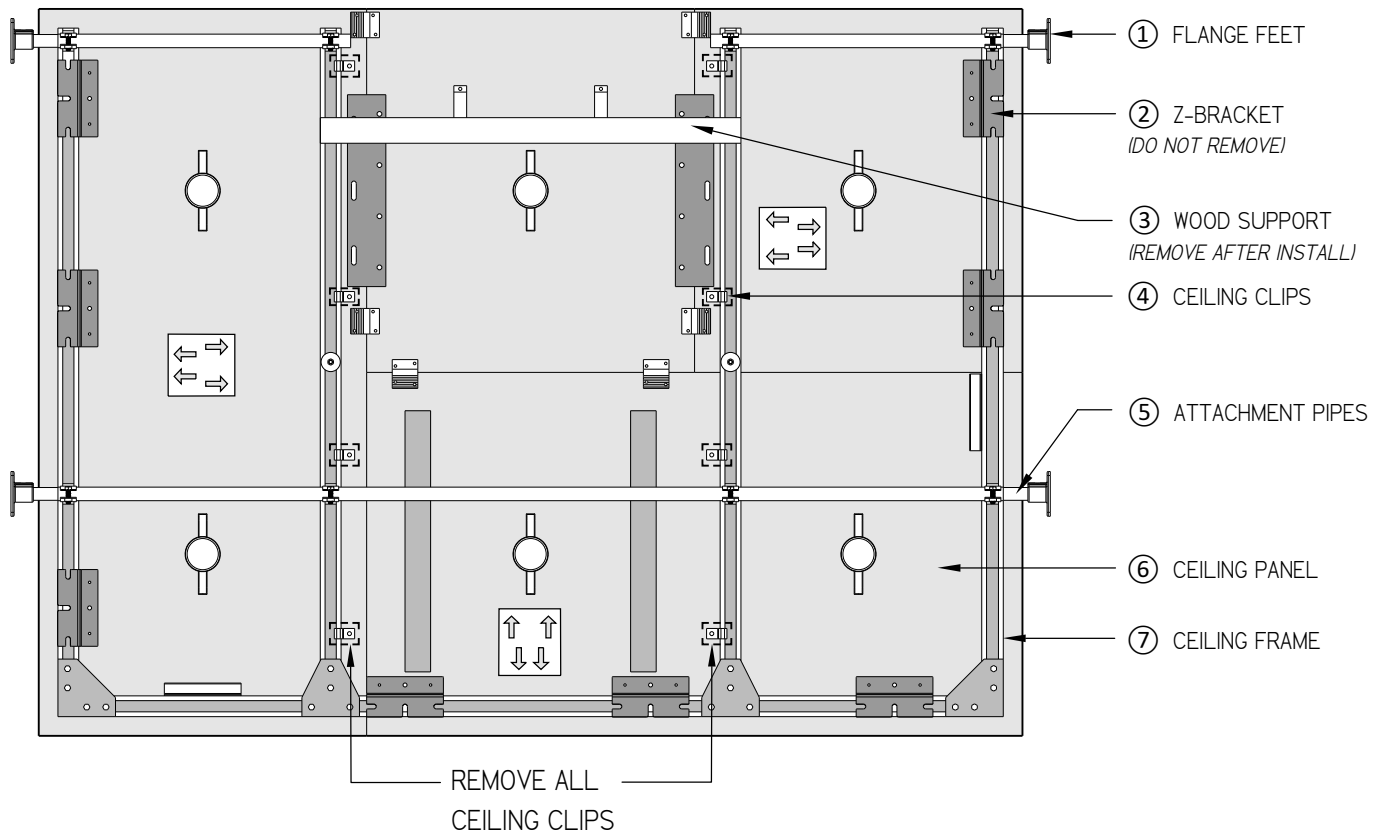

Preparation

Complete Cab Interior Wall Panel Installation

Before beginning CabArray™ ceiling installation, it is imperative to complete installation of the wall panel system, including all reveals and friezes. This guide will walk you through the ceiling installation process once the cab interior is complete.

Prior to Ceiling Installation

- Ensure no equipment or wiring is present in locations where attachment flanges penetrate the shell wall or canopy
- Carefully unpack ceiling components
- For a detailed demonstration of CabArray™ ceiling installation, scan QR code to watch a short video

Preparatory Videos

Ceiling Installation

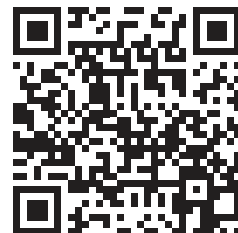

Installation Instructions

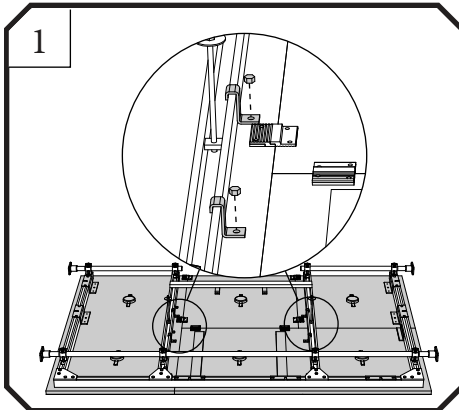

Remove Ceiling Panels

- Remove all ceiling clips ③ to detach panels from frame
- **Do not remove the Z-brackets ②** labeled on the ceiling substrates as they are crucial for ease of installation

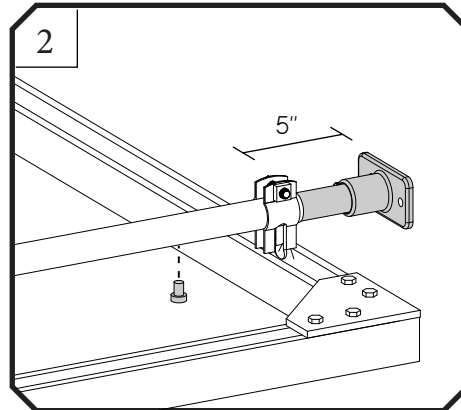

Preparing the Ceiling Frame

- Adjust ceiling attachment brackets by extending the flange feet ① 5" from edge of the ceiling frame and tighten using set screws
- Loosen side and back brackets for later adjustments

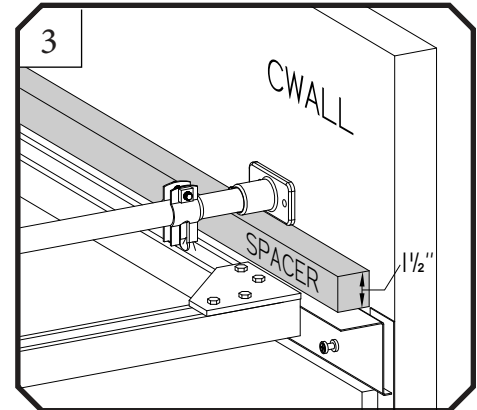

Positioning the Frame

- Place ceiling height spacer blocks on top of sidewall frieze
- Lift the frame and rest attachment pipes ⑤ on top of spacer blocks
- Slide the flange feet ① against the sidewall
- Repeat for opposite sidewall and backwall (if applicable) ensuring correct alignment

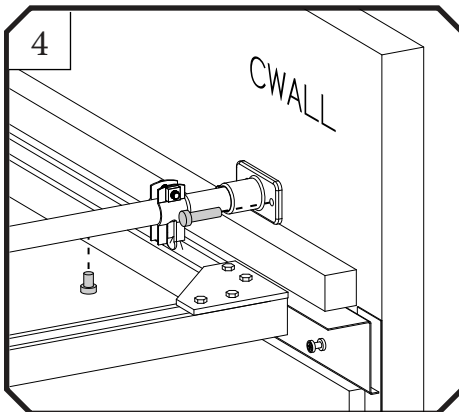

Securing the Frame

- Ensure frame's distance to each sidewall is equal and correctly positioned
- Check front to back positioning, typically 2" to backwall and 1" to front
- Secure attachment brackets to cabshell on both sidewalls (and backwall if required) using #14 screws
- Replace set screws with self-tapping screws in the round ceiling attachment pipes ⑤ to lock them in place

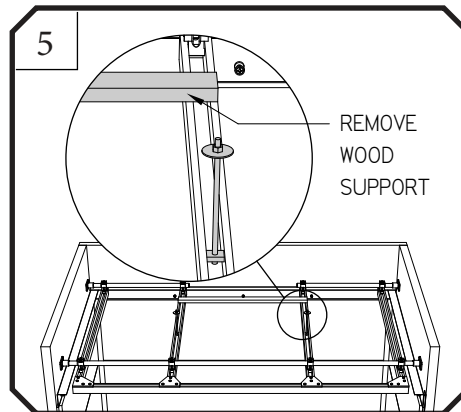

Additional Brackets

- Install two-threaded rod hanging brackets, considering cartop equipment and wiring
- Adjust location if necessary
- Remove ceiling height spacer blocks and wood support from top of ceiling frame

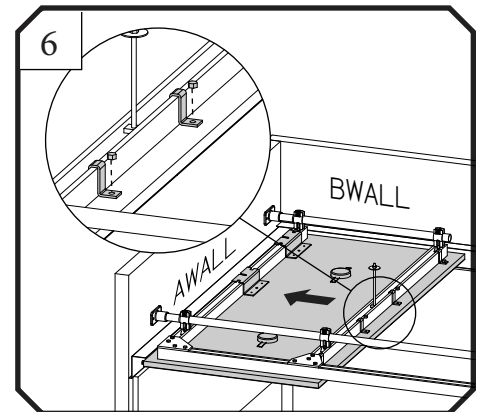

Installing the Ceiling Panels

- Slide Panel A onto the frame using Z-brackets ② to support
- Secure panel using clamps and ceiling clips ④ as indicated in project drawings

NOTE: For vent slots, consider using toggle bolts or through-bolting for additional security

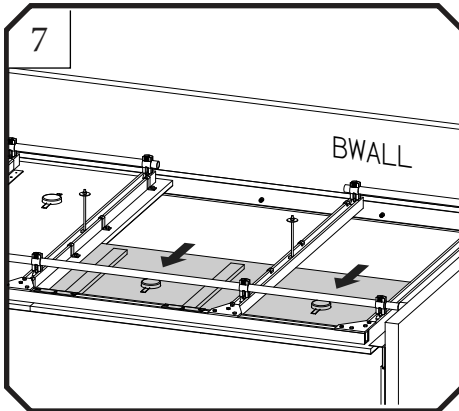

Installing the Ceiling Panels

- Repeat for Panel B, ensuring alignment and secure fitting
- Secure panel using clamps and ceiling clips ④ as indicated in project drawings

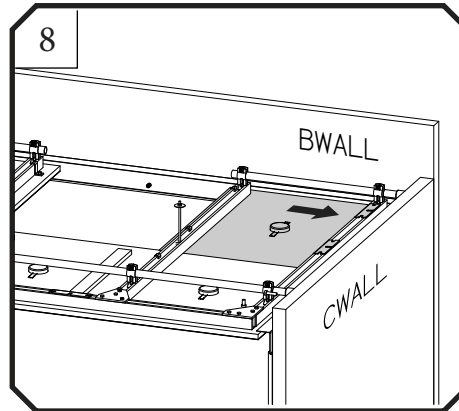

Installing the Ceiling Panels

- Temporarily place Panel D on the green felt strips above the ceiling for ease of Panel C installation
- Install Panel C using the same method, reusing the ceiling clips ④

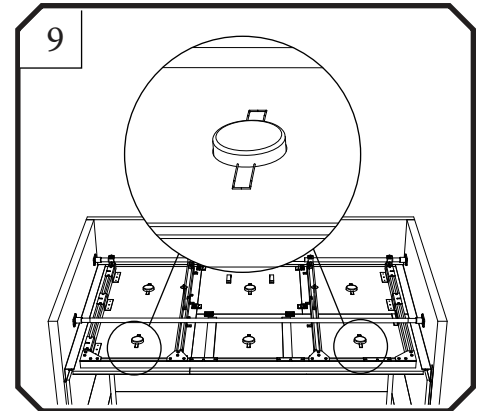

Ceiling Power Supply Installation

- **This step requires a trained elevator service technician**
- Connect and test the lights, including battery backup circuit
- The power supply includes battery backup, dimmer control, and requires 120V AC circuit

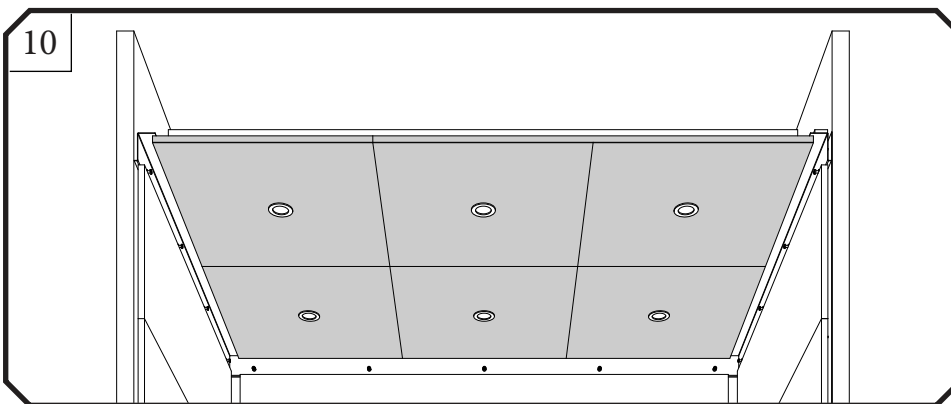

Finalizing Installation

- Secure the escape hatch, adjusting attachment plates or angles if necessary
- Slide Panel D into place and secure along with escape hatch using provided hardware
- Install thumb screws and engage any latches for the escape hatch
- Remove protective film from the frames
- Clean off any dust or fingerprints for a polished look